



Construction

Energy saving variable speed circulating pump driven by a permanent magnet synchronous motor (pm) controlled by on board inverter.

Applications

Heating and conditioning systems.

Operating conditions

- Liquid temperature from +2 °C to +110 °C
- Ambient temperature from 0 °C to +40 °C
- Maximum permissible working pressure: 10 bar
- Storage: -20°C/+70°C max. relative humidity 95% at 40 °C
- Certifications: in conformity with CE requirements
- Sound pressure \leq 40 dB (A).
- Minimum suction pressure: - 0,05 bar at 75 °C
- 0,28 bar a 90 °C.
- Maximum glycol quantity: 20%.
- EMC according to: EN 55014-1, EN 55014-2
EN 61000-3-2, EN 61000-3-2.
- Connections: Flanges according to PN 6/10, EN 1092-2, DN 32, 40, 50.
- The benchmark for most efficient circulators is $EEL \leq 0,20$.

Designation

NCE D HQ 40 F - 120 / 250

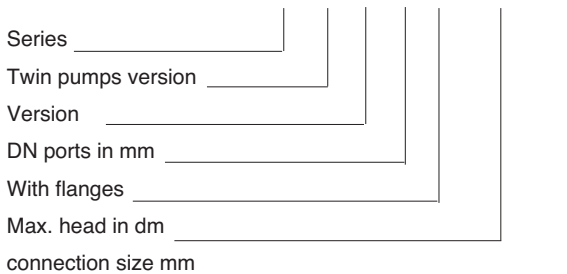

Motor

Synchronous motor with permanent magnet.

- Motor: variable speed
- Standard voltage: single-phase 230 V (-10%;+6%)
- Frequency: 50-60 Hz
- Protection: IP 44
- Insulation class: F
- Overload protection (integrated).
- Cable: phases and neutral.
- Constructed in accordance with: EN 60335-1, EN 60335-2-51.
- Additional module: - analog input 0-10V
- remote on/off input
- output relay

Features

Smart pump

NCED HQ.F adapt its functions to the system: the circulator measures the pressure and the flow and adjusts the speed to the selected pressure.

Easy use

There are different operating modes selectable from the control panel.

Operation

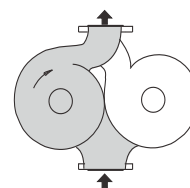

Single operation

Operation of a single pump chosen by the customer, with the second pump on stand-by

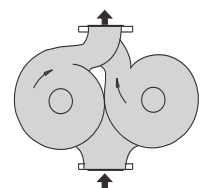

Double operation

Operation in parallel of the two pumps

Operating modes



Automatic mode

(factory setting):

In this mode the pump automatically sets the operating pressure, depending on the hydraulic system. This mode is recommended in most systems.



Proportional pressure mode:

The circulator changes the pressure proportionally to the current flow. The pressure value can be adjusted with the + and - buttons.



Constant pressure mode:

The circulator maintains the pressure constant when the reference flow changes. The pressure value can be adjusted with the + and - buttons.



Fixed speed mode:

The circulator works with constant curve and the curve could be changed using + e - buttons.



Night mode:

When the liquid temperature fall by 15-20°C the pump automatically swiches to night mode, in practice the circulator works at minimum curve. When the temperature rises again the pump comes back to the selected mode. The night mode could be selected with any operating mode.

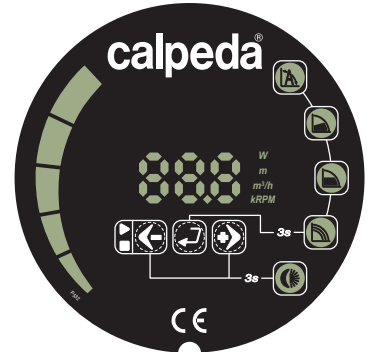

Operating mode-control panel

NCED HQ.F could works in:

- automatic mode
- proportional pressure mode
- constant pressure mode
- fixed speed mode
- night mode

The night mode could be selected with any operating mode.

Coverage chart

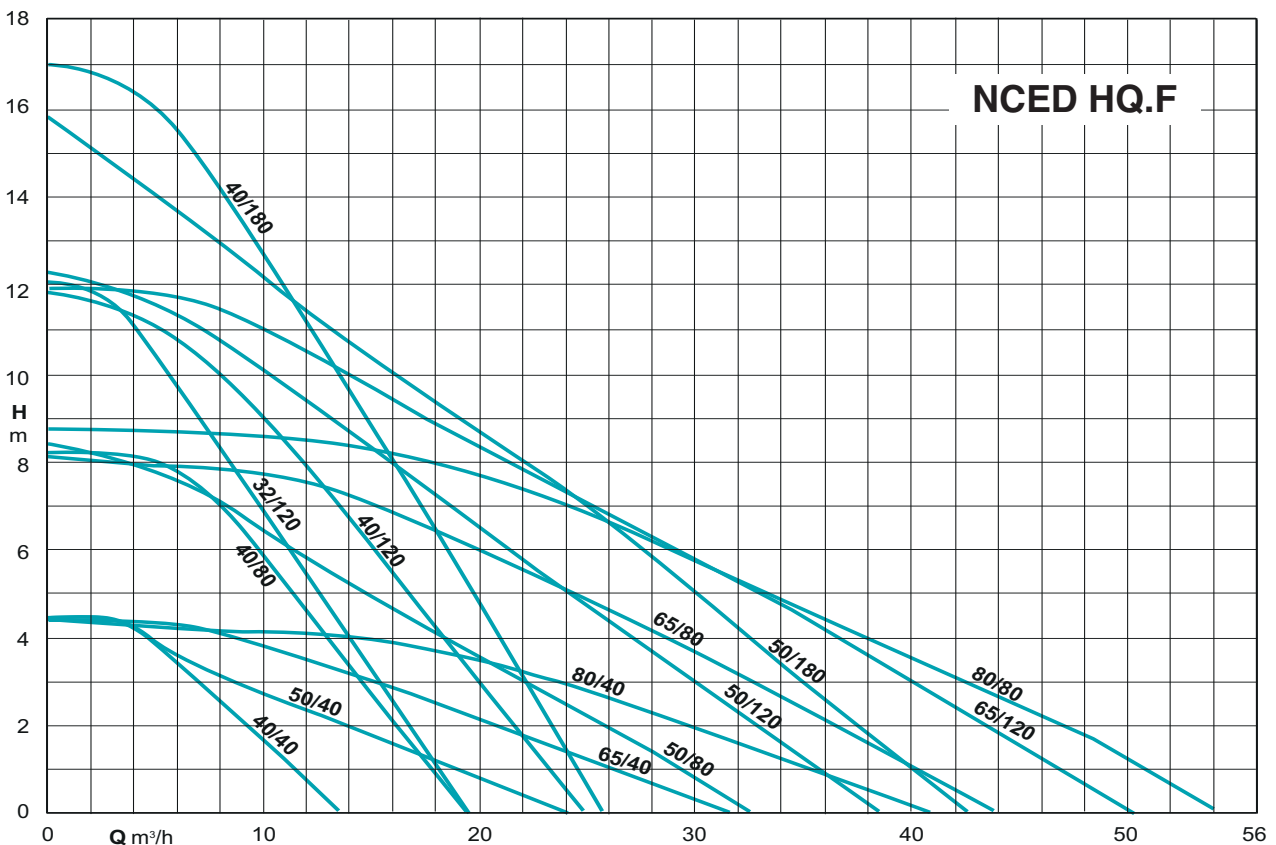

Characteristic curves

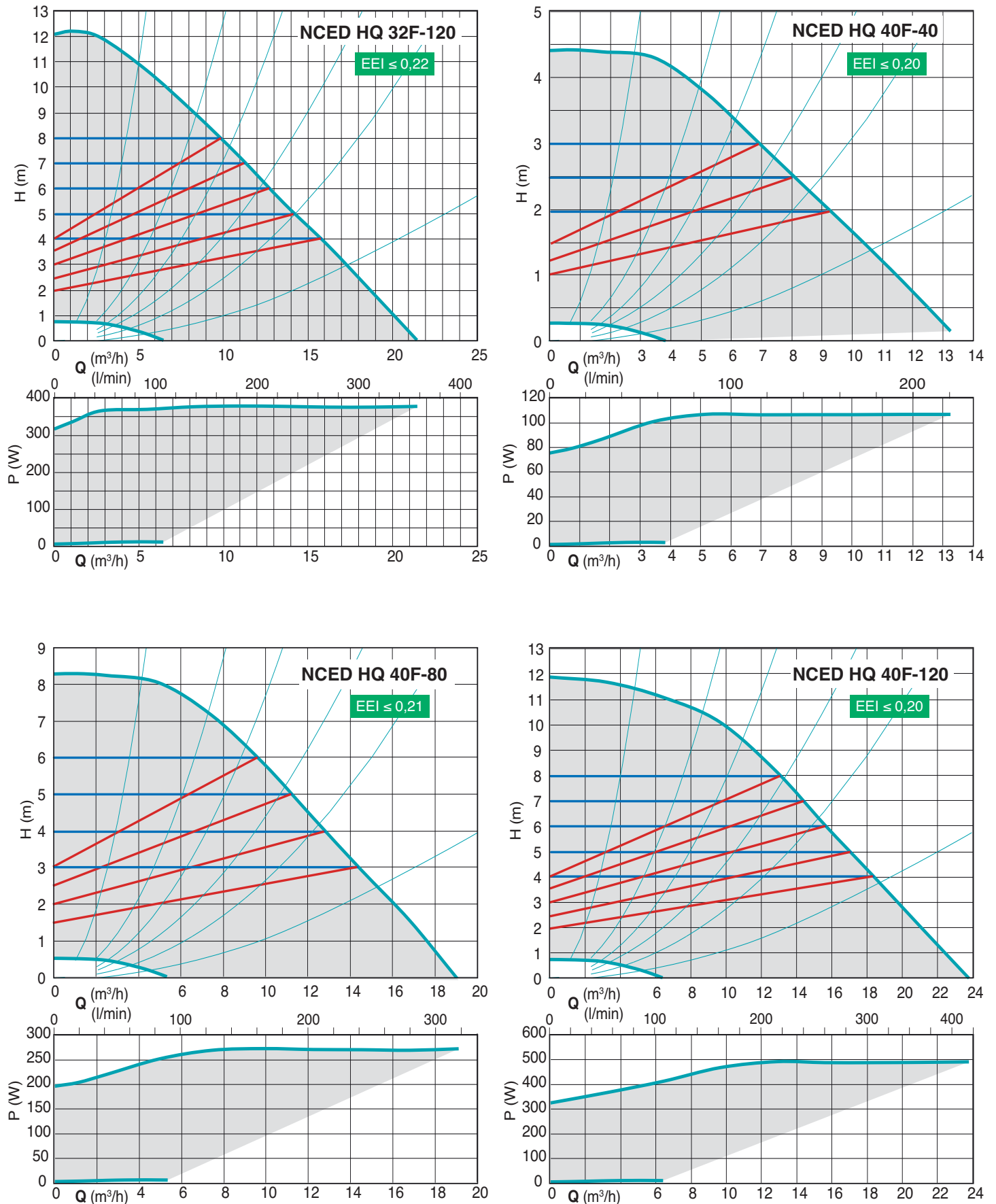

Characteristic curves

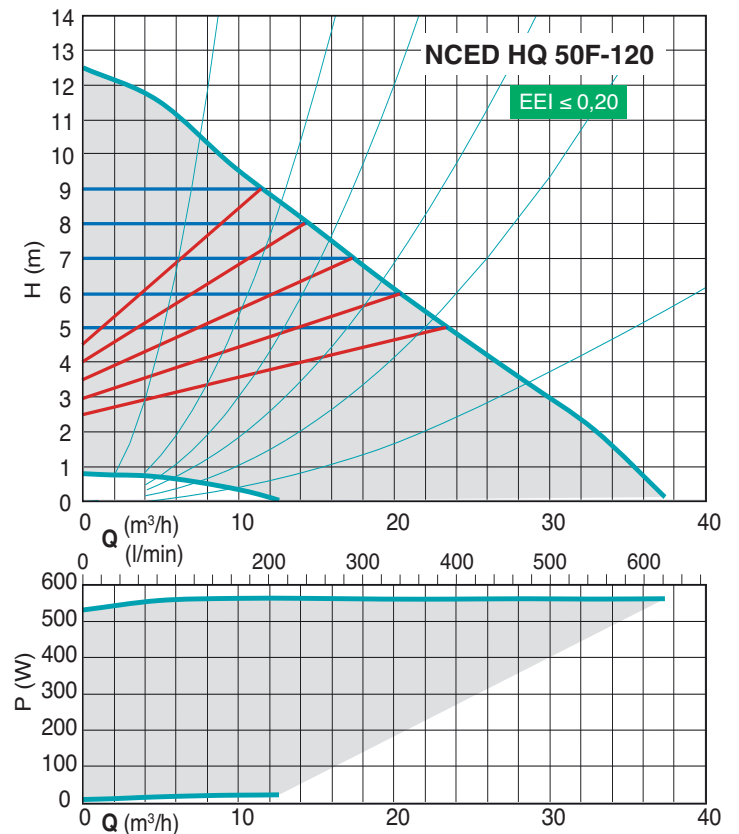
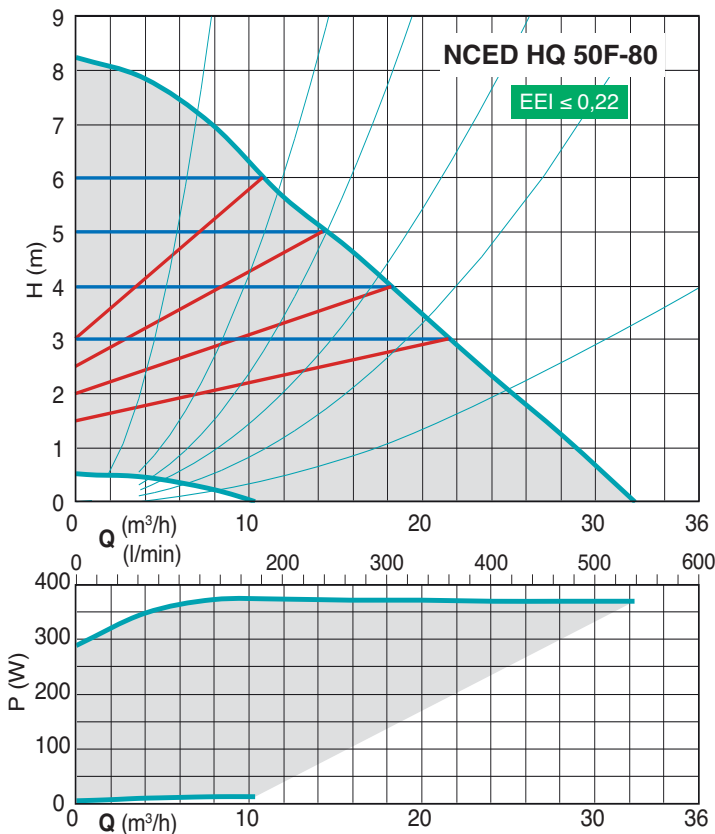
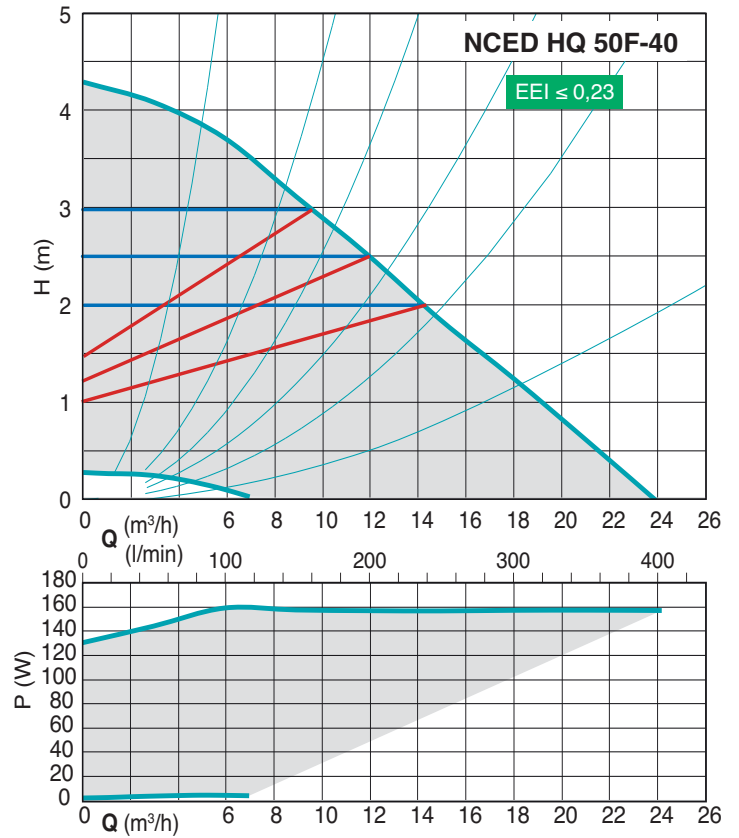
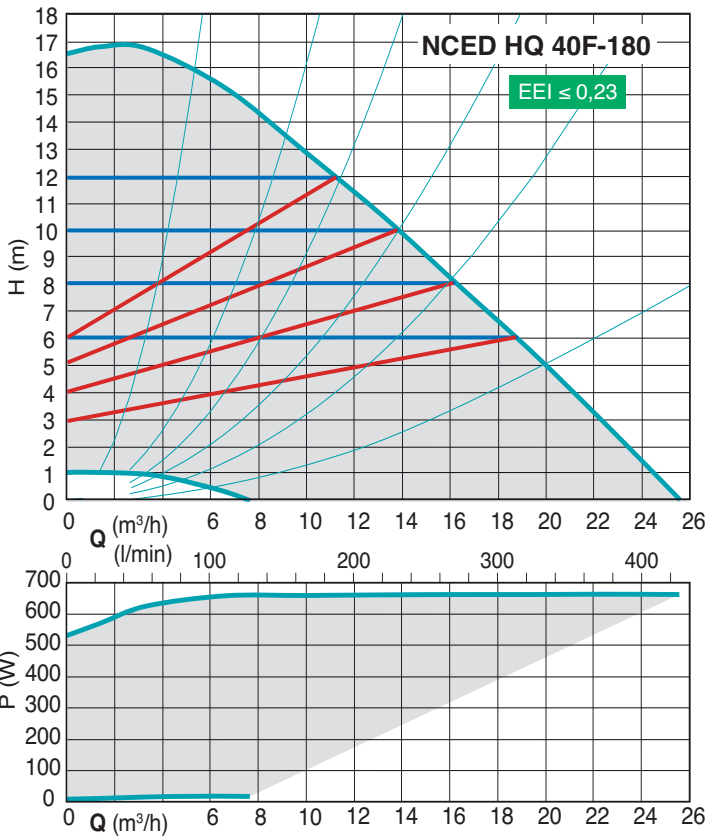

Characteristic curves

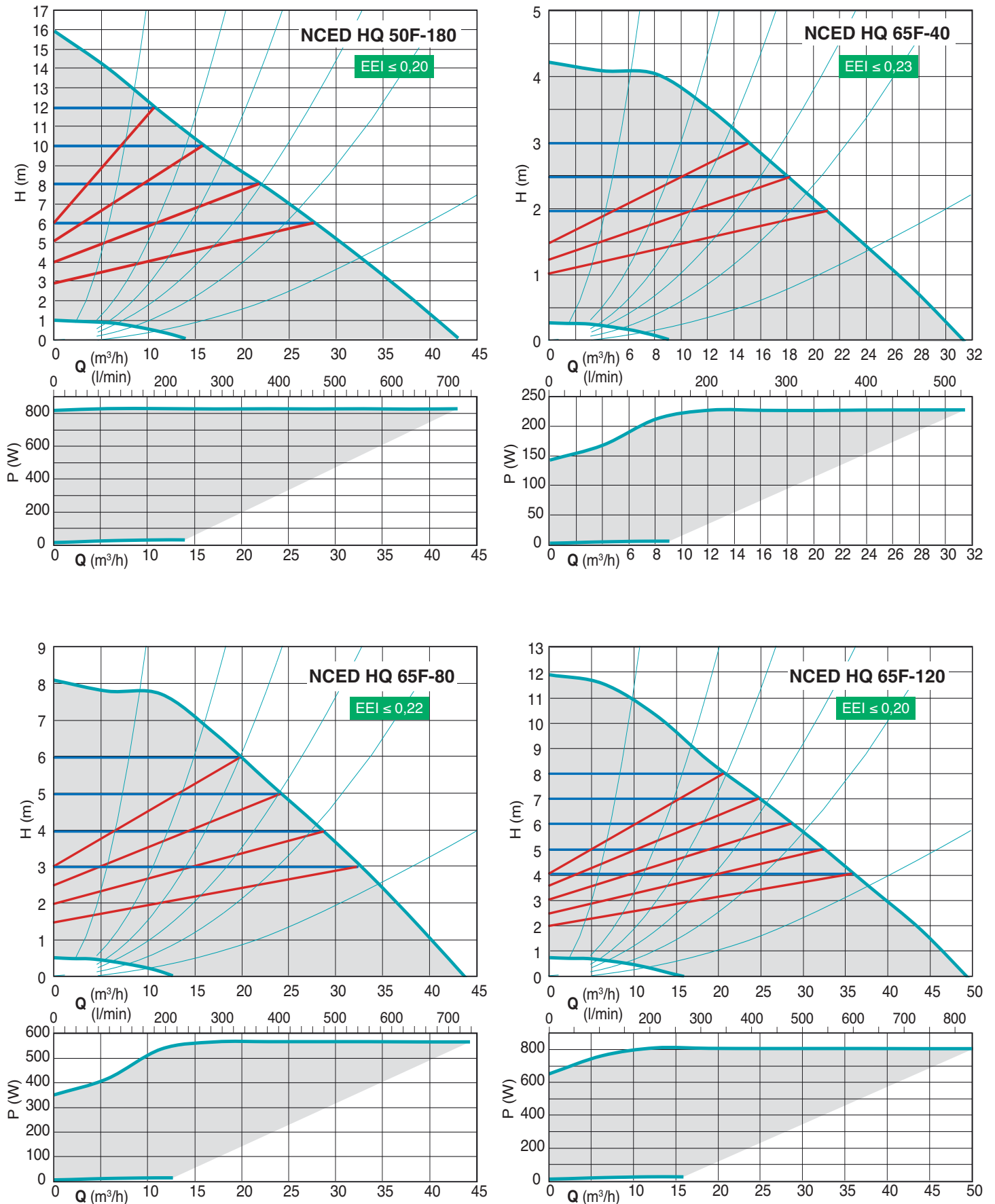

Characteristic curves

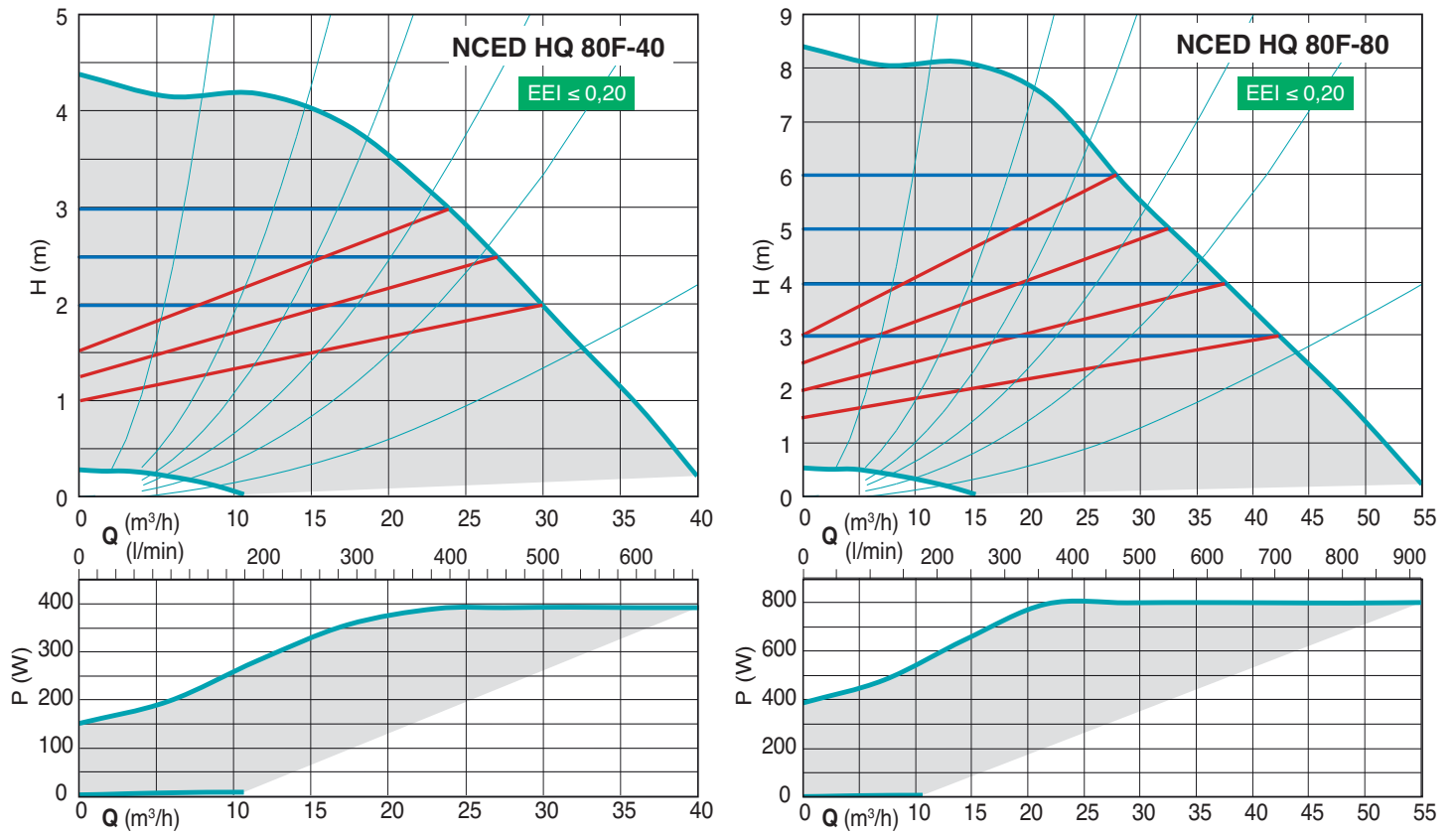

Materials

Component	Pos.	Material
Pump casing	1	Cast iron GJL 200 EN 1561
Impeller	2	Composite
Shaft	3	Stainless steel
Bearings	4	Carbon
Thrust bearing	5	Ceramic
Rotor	6	Stainless steel jacket
Winding	7	Copper wire
Electronic card	8	-
Gasket	9	EPDM

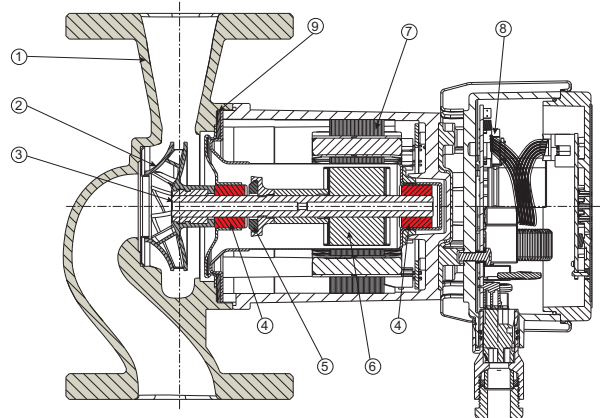

Examples of installations

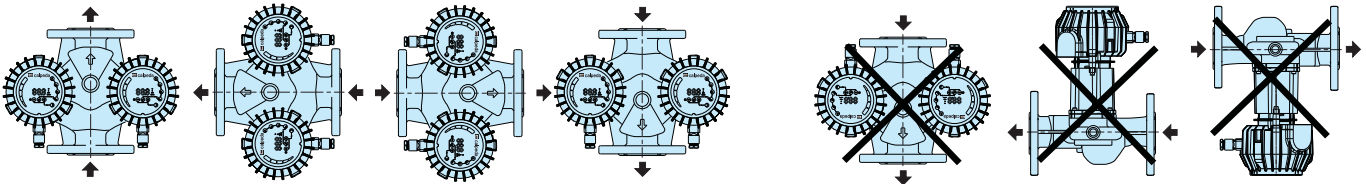

Dimensions and weights

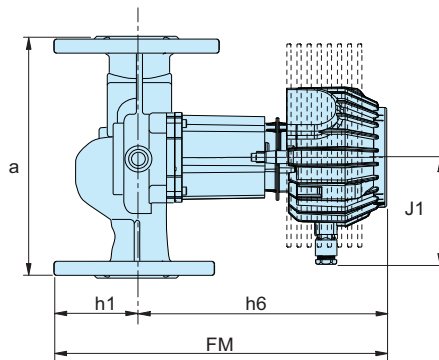
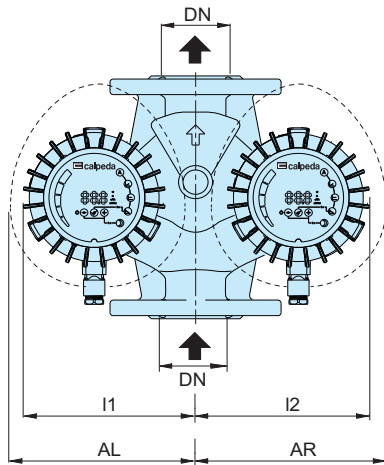

DN 32,40,50, 65

PN6/10

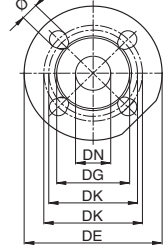

DN 80

PN10

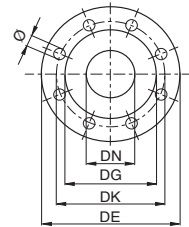

DN	DE	DK	DG	holes	
				N.	Ø
32	140	90/100	74	4	14/19
40	150	100/110	80	4	14/19
50	165	110/125	90	4	14/19
65	185	130/145	110	4	14/19
80	200	160	128	8	19

TYPE	DN	H m	Q m ³ /h	1~ 230 V		P ₁		mm								kg	
				A min	A max	W min	W max	a	J1	FM	h1	h6	I1	I2	AL		AR
NCED HQ 32F-120/220	32	12	19	0,2	1,7	25	370	220	115	330	65	265	-	-	185	186	-
NCED HQ 40F-40/250	40	4	13	0,1	1	10	110	250	99	270	65	205	181	186	-	-	14,3
NCED HQ 40F-80/250	40	8	19	0,2	1,4	25	270	250	115	330	65	265	-	-	185	186	16,7
NCED HQ 40F-120/250	40	12	24	0,2	2,2	25	480	250	115	330	65	265	-	-	185	186	16,9
NCED HQ 40F-180/250	40	18	25	0,2	2,9	25	680	250	115	390	65	325	-	-	200	200	25
NCED HQ 50F-40/280	50	4	23	0,1	1,3	10	160	280	99	313	72	241	199	200	-	-	19,6
NCED HQ 50F-80/280	50	8	32	0,2	2	25	370	280	115	373	72	301	199	200	-	-	22,4
NCED HQ 50F-120/280	50	12	36	0,2	2,5	25	560	280	115	373	72	301	199	200	-	-	23,6
NCED HQ 50F-180/280	50	18	42	0,2	3,6	25	830	280	115	373	72	311	-	203	200	-	28,8
NCED HQ 65F-40/340	65	4	31	0,1	1,6	10	230	340	115	384	75	309	216	226	-	-	32,2
NCED HQ 65F-80/340	65	8	43	0,2	2,5	25	560	340	115	384	75	309	216	226	-	-	32,7
NCED HQ 65F-120/340	65	12	50	0,2	3,6	25	810	340	115	395	75	320	216	226	-	-	38,4
NCED HQ 80F-40/360	80	4	40	0,2	2,2	25	390	360	115	414	93	321	241	253	-	-	
NCED HQ 80F-80/360	80	8	53	0,2	3,6	25	800	360	115	425	93	332	241	253	-	-	